

**Installation Instructions  
Kit #71030**

**Conversion from Standard Fuel Tank  
to  
6 Gallon Tank**

***AMADAS***

---

**June 2007  
MAN102**

©2007

*Reel Rain Traveler Systems and associated parts are manufactured  
by Amadas Industries:*

*You can find us on the Web at:*

[www.amadas.com](http://www.amadas.com)

*or e-mail us at:*

[amadas@amadas.com](mailto:amadas@amadas.com)

P.O. Box 1833  
Suffolk, VA 23439  
(mailing)

1100 Holland Road  
Suffolk, VA 23434  
(shipping)

(757) 539-0231 (Phone)  
(757) 934-3264 (FAX)

P.O. Box 3687  
Albany, GA 31701  
(mailing)

1701 South Slappey Blvd.  
Albany, GA 31706  
(shipping)

(229) 439-2217 (Phone)  
(229) 439-9343 (FAX)

# Contents

---

Introduction .....	2
Safety .....	2
Parts .....	3
Drawing .....	4
Installation Instructions .....	5
Remove Existing Tank .....	5
Install New Tank .....	7

## Introduction

Use this manual to change the fuel tank on your Reel Rain Traveler System to a six-gallon tank. Please follow all safety recommendations and conversion instructions carefully.

These instructions apply to all models of gas engine Reel Rains. Your machine may or may not look exactly like the photos shown in the instructions, depending on your Reel Rain model. All of the same parts are used, regardless of machine model.

## Safety

Please read the following safety instructions before beginning:

- Handle fuel safely – do NOT smoke while handling fuel or tank. Do NOT perform conversion or store fuel or tank near any open flame.

- Do NOT perform conversion while Reel Rain is in operation.
- Make sure the reel brake is engaged. Please refer to your Reel Rain user manual for information on how to make sure the reel brake is engaged.



## Parts

The following parts are included in the conversion kit. Before beginning, please check your kit to make sure all parts are

have been included. Please contact if a part is missing or damaged for a replacement.

Part #	Description	Quantity	Drawing #
G120376	Nut, 5/15-18 Uss	4	
G120392	Washer, ¼ Sae Flat	4	
G126178	Nut, ¼-20 Serrated Flange	1	
G131085	Washer, 5/16 Uss Flat	14	
GS180020	Screw, ¼-20x3/4 Uss Cap	4	
GS180079	Screw, 5/16-18x1 Uss Cap	4	
GS180079T	Screw, 5/16-18x1 Tap. Washerhead	7	
128711	Mount, Gas Tank	1	3
128726	Mount, Brace Channel	1	4
128727	Mount, Angle	1	5
14542-21	Hose, ¼ ID Fuel Line	1	
14908	Valve, Ball; ¼" Press-in 90de	1	
20172	Bushing, Shock Mount, ¼"	4	2
20173	Grommet, Rubber, ¼" Fitting	1	
2363	Clamp, Adj.; ¼ Id Hose	2	
8125	Filter, In-Line Fuel	1	
8395	Tank, Fuel, Plastic 6gal, W/Cap	1	1

# Drawing

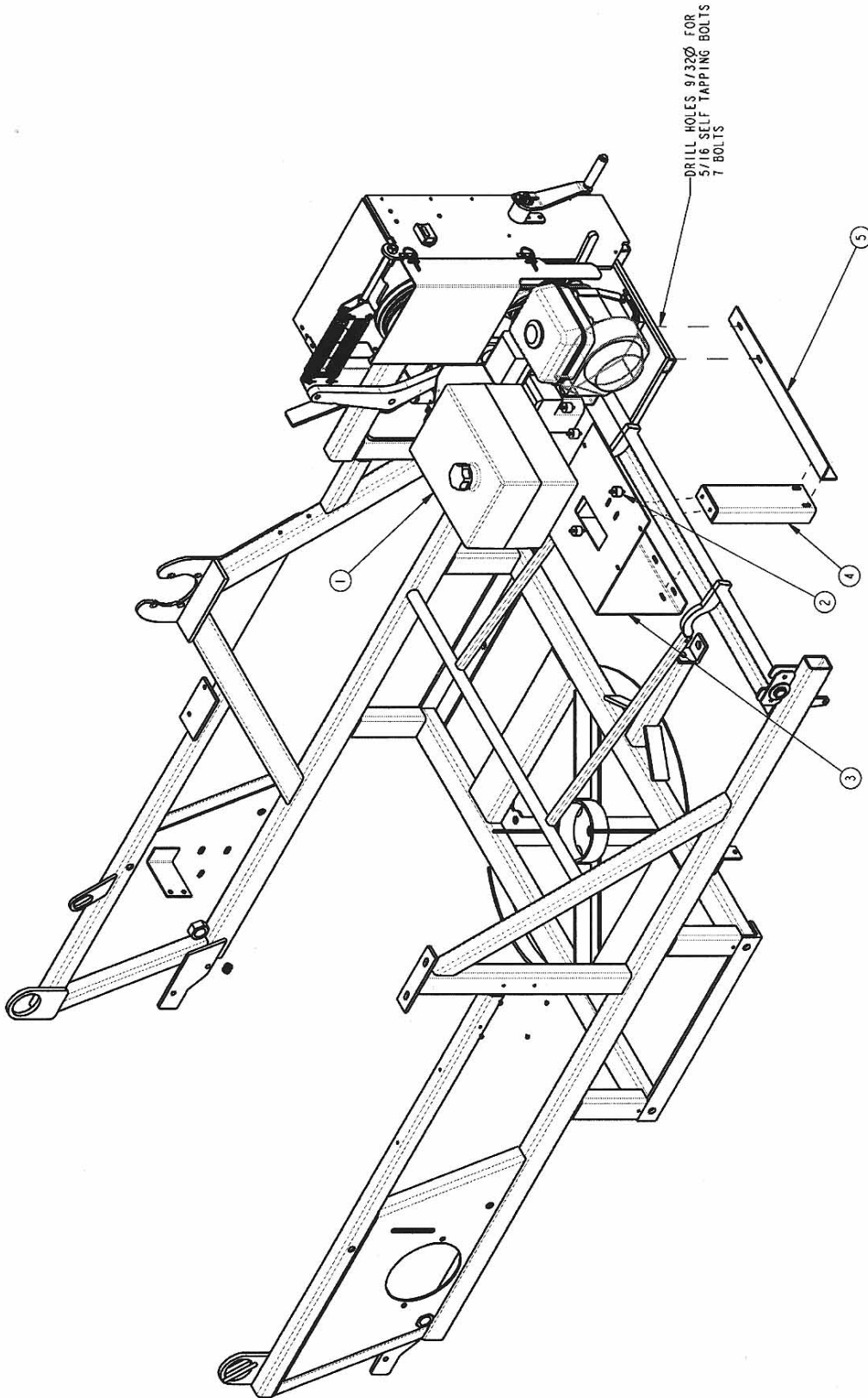

## Installation Instructions

### Remove Existing Tank

1. Make sure fuel switch on engine is set to off (top photo).
2. Drain all gas from the fuel tank. Follow all instructions for handling fuel safely.
3. Make sure the engine is turned off (middle photo) and has cooled completely.
4. Using a 10mm socket, remove the two nuts holding the fuel tank to the right-hand side of the engine (bottom photo).



**Remove Existing Tank**

5. Using a 6" extension and a 10mm socket, remove the bolt holding the fuel tank to the left hand side of the engine.
6. Lift the tank up as far as possible. Remove the wire clamp holding the fuel line to the tank.
7. Disconnect the fuel line from the engine and remove the fuel tank.



### Install New Tank

1. Press the fuel filter (part #8125) in the hose coming from the engine (top photo).
2. Install the main fuel line (part# 14542-21) to the end of the filter and clamp (part #2363) in place (top photo).
3. Screw the four vibration mounts (part #20172) into the tank (part #8395) (middle photo).
4. Press the grommet (part #20173) and valve (part #14908) into the bottom of the fuel tank (bottom photo).

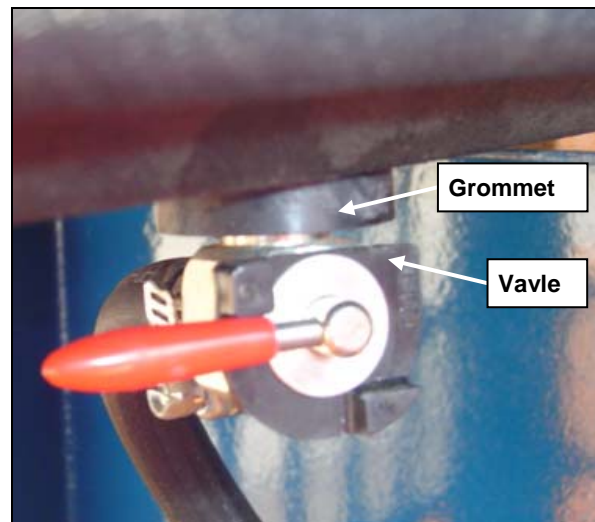
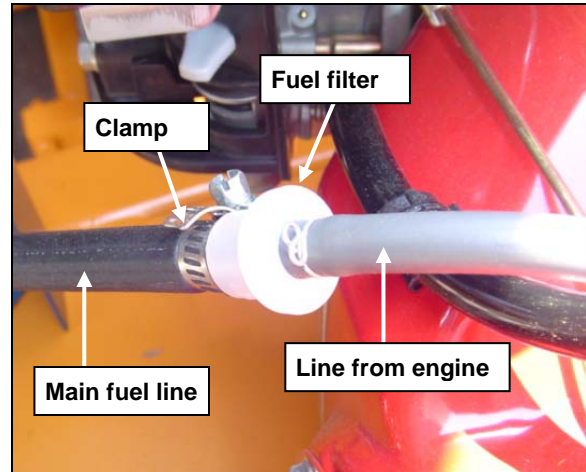

**Install New Tank**

Refer to the drawing on this page and the full drawing on page 4.

5. Attach the fuel tank to the gas tank mount (part #128711).
6. Loosely assemble the brace channel mount (part #128726 and the angle mount (part #128727) on the engine.
7. Level the tank, square it to the machine, and tighten all of the fasteners.
8. Cut the fuel line to the required length and install on valve (middle photo).
9. Install the hose clamp (middle photo).
10. Put a small amount of fuel in the tank and check for leaks. If there are no leaks, the machine is ready to run.

**IMPORTANT!** When you transport the irrigator, make sure the fuel valve on the bottom of the tank is turned off as well as the valve on the engine.

